

High Flow Accumulator

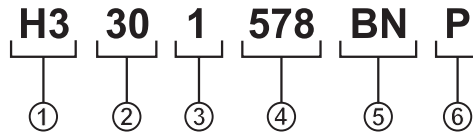

Model Code



① Type

H3 - Accumulator, high flow

② Pressure Rating

30 - (3000 psi)

③ Port configuration

- 1 - NPT (not recommended)
- 2 - SAE
- 3 - SPF

④ Size

- 578 - 9.46L (2.5 USgal.)
- 05G - 18.9L (5 USgal.)
- 10G - 37.9L (10 USgal.)
- 11G - 41.62L (11 USgal.)
- 15G - 56.8L (15 USgal.)

⑤ Bladder Material

- BN - Buna-N (std.)
- VT - Viton
- BL - Butyl
- EP - EPR
- CW - Cold weather
- HL - Hydrin

⑥ Service

- P - Petroleum oil
- W - Water
- S - Stainless steel
- SPC - Special

Installation Dimensions

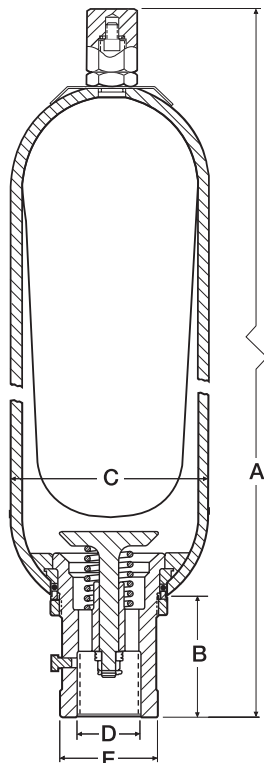

Fluid Port
H3-1 (4¼"-8 UN-2 SAE)
H3-2 (4"-8 NPT)

High Flow Bladder Accumulators - 3000 PSI

Size (Gal.)	Gas Volume (In ³)	A (In.)	B (In.)	C (In.)	Weight (Lbs.)
2.5	600	22.5	5.375	9.0625	80
5	1203	34.75	5.375	9.0625	120
10	2259	55.5	5.375	9.0625	220
11	2535	61.0	5.375	9.0625	240
15	3440	79.0	5.375	9.0625	305

Fluid Port Repair Kits

Model	Part Number
H3 30 A 578 BN	02-316874
H3 30 A 15G BN	02-316874

Seal Kits

Model	Part Number
H3 30 578 BN	02-317650
H3 30 15G BN	02-317650

Bladders

Model	Part Number
H3 30 578 BN	02-316682
H3 30 05G BN	02-316683
H3 30 10G BN	02-316684
H3 30 15G BN	02-316685